



Hypertherm Plasma Cutter and Consumables

Version 8.27

Plasma Cutters: We always recommend purchasing Hypertherm. It's simply the best. Make sure you get the machine torch, with CPC port. You'll also need an ohmic cap.

	Max Cut	Pierce	Part #	Consumables
Powermax 45	7/8"	1/2"	HYP088121	851512
Powermax 65	1"	5/8"	HYP083294	851466
Powermax 85	1-1/4"	3/4"	HYP087132	851469

For most users, the Powermax45 XP is plenty. Here's a convenient cheat sheet for the consumable part numbers:

Mechanized shielded consumables with ohmic retaining cap

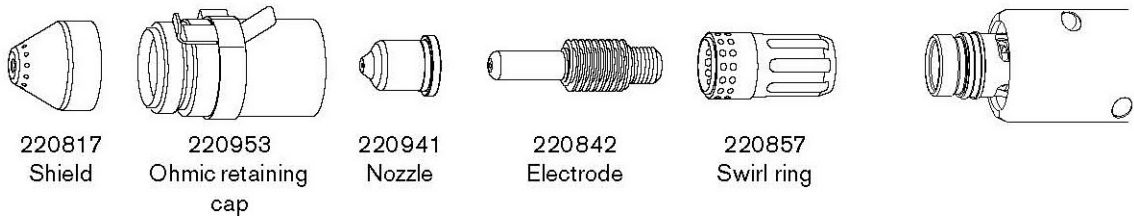

FineCut shielded consumables with ohmic retaining cap

